

15

14

13

# BONDURANT WALKING TOUR

*AN EMBODIED MAP EXPERIENCE*

22

L

23

A

24

S

340

27

26

25

343

BONDURANT

348

348

351

350

34

35 G.W.

36

C. and

R.R.

367

366

365

364

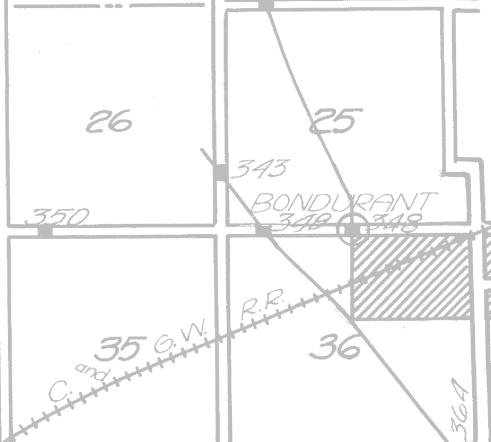

## 1 *LIBRARY*

As you walk out of the library towards Main Street, 78<sup>th</sup> street will cross in front of you. When you cross the street, look to your left to see the iconic skyline of the Bondurant Grain Silos. The railway system used to be the major transportation system in the United States. Now we rely on cars and highways. Where do you see this transformation? Can you hear it?

## 2 *GRAIN SILOS*

As you walk up Main Street, the Grain Silos will be on your left. Take a stroll up to them. Home to the Farmers Cooperative, you can see where the train would stop on its way to Chicago to fill up with grain. Iowa was (and still is) producing massive amounts of corn and soybeans. As you walk closer to the Silos, how does your perspective shift on the scale of this production?



### 3 TRAIN STATION

Continuing up Main Street, you will hit the beginning of the Chichaqua Valley Trail. Turn right and you will arrive at the old Bondurant Train Station. Trains were also the major transportation system for people. People had the ability to travel to Kansas City, Minneapolis, Des Moines, and Chicago. Train stations were meeting places with the energy of coming and going. What kind of bustle do you see now? As you continue to walk, how many references to the railroad can you find?

### 4 SCHOOL MURAL

Keep walking on the Chichaqua Trail and eventually you will come to a point where you can sit down on a bench to look at a mural titled *Taking Off*. Taking a moment to view the mural, what does this art say about Bondurant?



## 5 CHICHAQUA TRAIL

This location also marks the place where you can continue down the Chichaqua Trail all the way to Des Moines! By continuing down the trail, you may see a red squirrel eating acorns in a tree or hear a robin from up above. You'll see oak and hickory, and not before long, you will cross over Mud Creek.

## 6 CITY PARK/CEMETERY

After you have explored the trail, continue south on Grant Street and turn left onto 2nd Street. Walking up these neighborhood blocks, eventually, you will come upon City Park. If you continue down this street, you will reach the Bondurant cemetery. This cemetery was started in 1888, and 2<sup>nd</sup> Street was one of the first roads built in the town so that people could see their loved ones in the cemetery.



## DOWNTOWN

### 7

Across the street from City Park, located on a white fence, a colorful mural titled, *Change in Seasons*, will welcome you to Downtown Bondurant.

### 8

As you stroll through downtown you may get a whiff of pie from Home Slice Handmade Pies or see a gathering of friends getting coffee outside of Somewhere in the Middle Coffee shop. As you walk down Main Street, you will walk by home goods stores, restaurants, craft stores, and cafés.

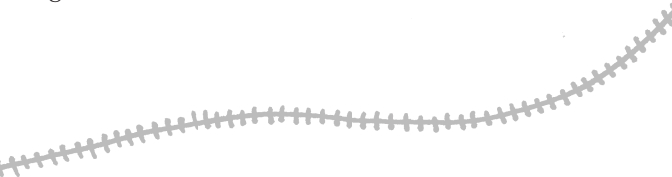

## 9

When you make it to the white building on Main Street that is currently the restaurant Flame, take a pause. This building used to be a barber shop, a hardware store, the post office, and the library.

## 10

If you look directly across Main street, that building used to be the first general store as well as a hotel.



## 11

Diagonally across the street, you can also see the building where Founders Irish Pub and the Farm Bureau Finance Services are located. This is the original building that used to house a grocery store, bank, post office, and café.

## 12

The other original building is what is now Reclaimed Rails Brewing Company. This used to be the American Legions building. As you take in the bustle and energy of downtown, know that there have been many generations of people who have used this space as a communal gathering center.



15

14

13

You are holding part of a collaborative project enacted through the Iowa Initiative for Sustainable Communities. *Bondurant Walking Tour: An Embodied Map Experience* was charted and written by Sophia McLaughlin. This pamphlet was designed by Tegan Daly in November 2023.

28

L

25

A

24

S

340

27

26

25

343

BONDURANT

351

350

348

348

34

35 G.W.  
C. and R.R.

36

367  
366  
365

364